

Operating instructions scalachair X3



800.577.1555

info@max-ability.com

www.max-ability.com

1275 Fourth Street

Suite 304

Santa Rosa, CA 95404

Handle left:
Selection of direction

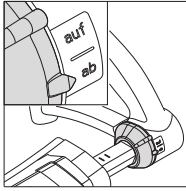

Handle right:
Activation of climbing mechanism

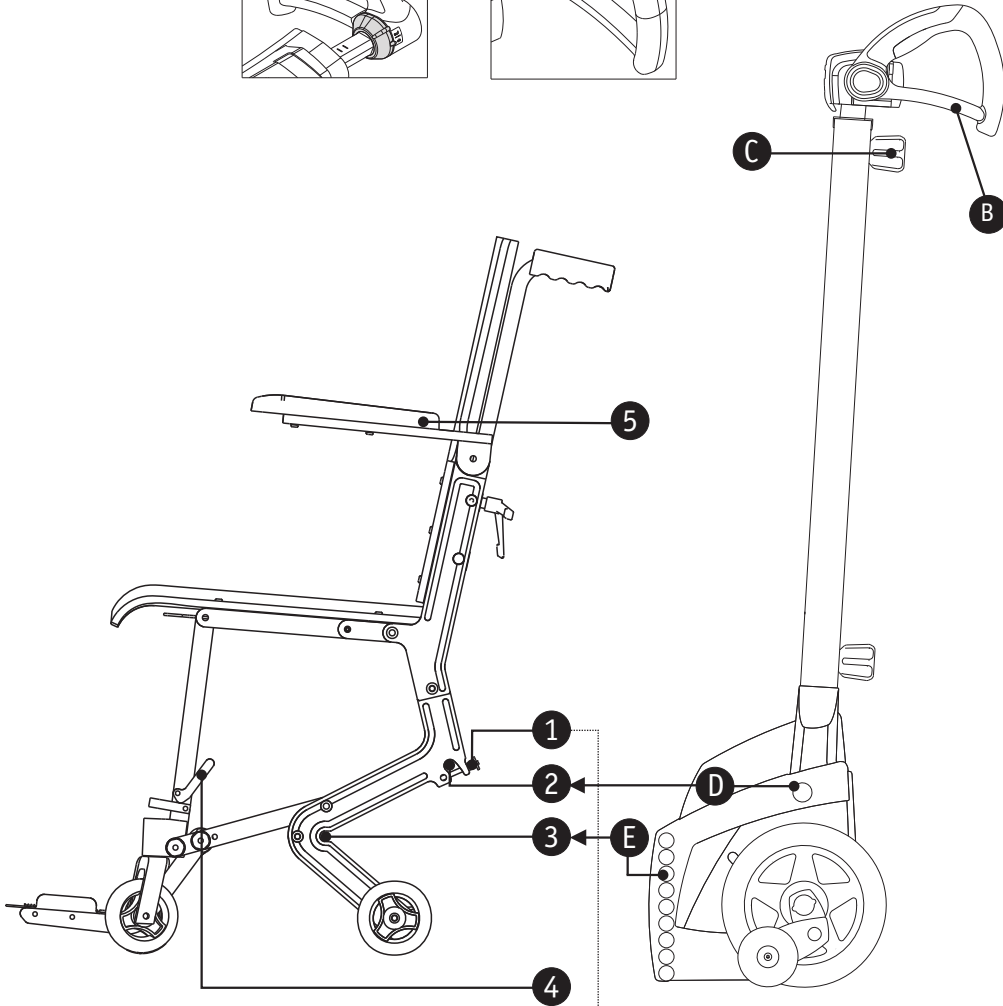
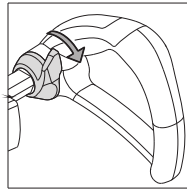

Use of the locking pins [1]:

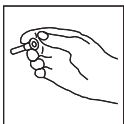

The locking pin is held correctly this way

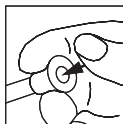

When inserting or withdrawing the locking pin, always use the thumb to press on the center of the locking pin

Please note: If it's not completely clear how to handle the scalachair correctly, please refer to your local medical supplies dealer or directly to the alber customer service. The same is recommended if problems arise when fitting an existing scalamobil to a new scalachair X3.

Assembly

Your scalachair X3 is delivered ready to use. To assemble the scalachair, please follow the instructions below:

- Secure the scalachair with the brakes [4] (simply turn the brake levers on both sides).
- Take hold of the retaining pin [1], as shown on page 10, and pull it out (left and right).
- Center the scalamobil and run it under the scalachair
- Push the scalamobil into the scalachair until the lower bolt [E] stops at position [3] in the frame of the scalachair.
- Move the scalamobil's selection switch [A1] in the direction "UP". Then press the scalamobil's driving switch [A2] until the back wheels of the scalachair lift up. The upper bolt [D] then moves into the holding slot [2].
- Secure the connection by inserting the retaining pins [1] into the holding slots [2] (left and right), follow the instructions on page 10.
- Move the scalamobil's selection switch [A1] in the direction "DOWN" and press shortly the driving switch [A2] until the wheels of the scalachair are again touching the floor.
- Loosen the screw knobs on both sides [C] and set the handles [B] to the height of your shoulder.
- Tighten the screw knobs firmly [C].
- Release the brakes [4] before beginning the transport (left and right side).

Please, under all circumstances take note of the safety instructions on page 14!

Handle left:
Selection of direction

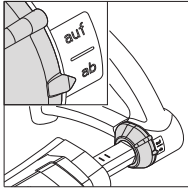

Handle right:
Activation of climbing mechanism

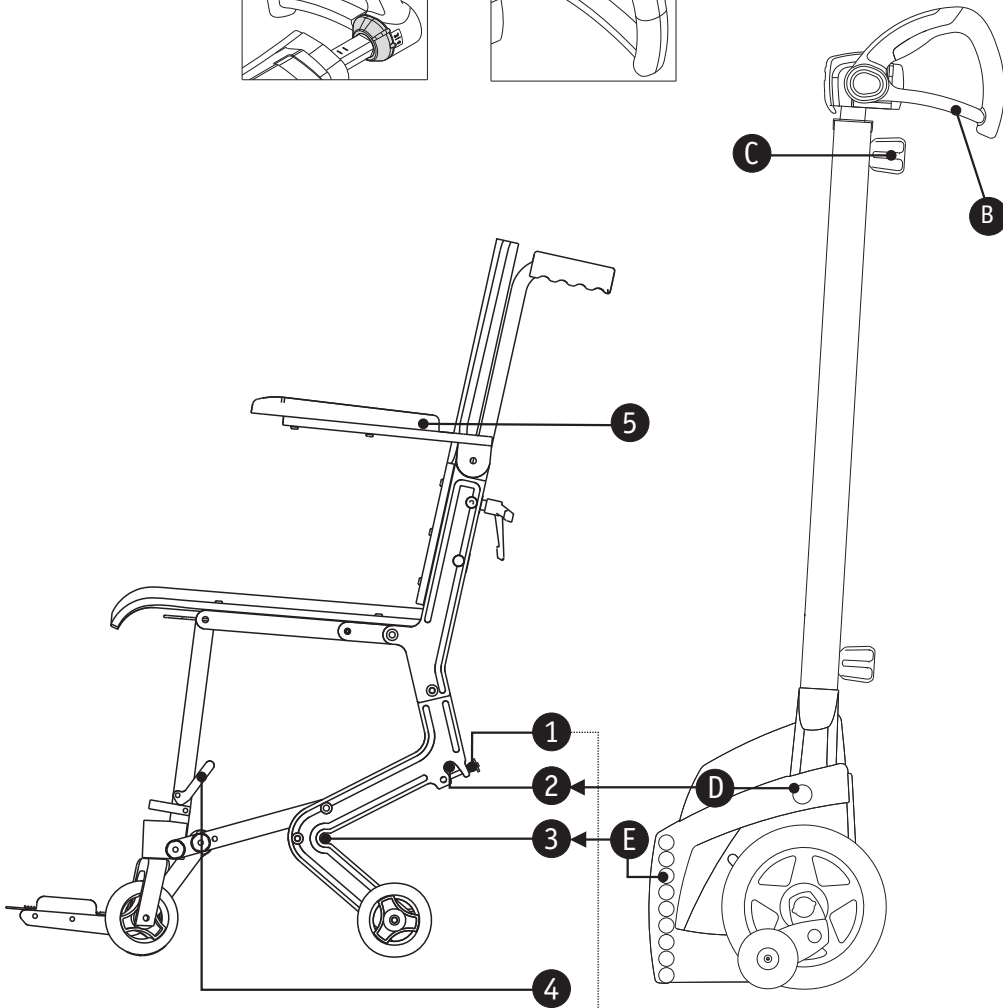
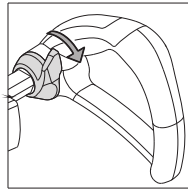

Use of the locking pins [1]:

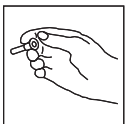

The locking pin is held correctly this way

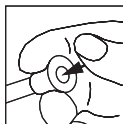

When inserting or withdrawing the locking pin, always use the thumb to press on the center of the locking pin

Dismantling

To remove the scalachair X3 from the scalamobil, please do the following:

- Secure the scalachair by means of the brakes [4] on both sides.
- Move the scalamobil's selection switch [A1] in the direction "UP". Then push the driving switch [A2] until the back wheels of the scalachair lift up.
- Remove the retaining pins [1] from the upper holding slot [2] (left and right side).
- Move the scalamobil's selection switch [A1] in the direction "DOWN". Then press the scalamobil's driving switch [A2] until the back wheels of the scalachair touch down.
- Pull the scalamobil out from under the scalachair .
- Return the retaining pins to the upper holding slots [2], follow the instructions on page 4.
- Before you begin to push the scalachair, release the brakes [4] on both sides .

To ease the insertion and the withdrawal of the scalamobil under the scalachair you should tilt the scalamobil slightly in your direction.

Technical Data

Weight:	12.8 kg
Width/height/depth:	51/95/68 cm
Width/height/depth:	51/95/34 cm (folded)
Max. loading:	140 kg (weight of occupant)

Please, under all circumstances take note of the safety instructions on page 14!

Safety instructions

- Please read the operating instructions of scalamobil before using the scalamobil in combination with scalachair X3.
- When loading or unloading passengers, make sure it's done on solid, level surfaces.
- Set the brakes [4] on the scalachair as shown on page 4 while loading or unloading passengers. To ease the loading and unloading process, the armrests [5] can be folded upward (both sides). For safety reasons these must be lowered back into position before transport begins.
- Carry out loading and unloading of passengers without the scalamobil.
- Give attention to the proper positioning of the bolts [D] and [E] in the guide slots [2] and [3] of the scalachair (see drawing on page 12).
- Make sure the retaining pins have been clicked into place after every assembly or disassembly.
- Always tighten the screw knobs [C] firmly.
- During transport, the feet of the passenger should be on the footrest.
- Use your scalachair only for passenger transport, and observe the maximum loading capacity of 140 kg!
- After transport and unfolding of the scalachair, make sure the seat locking bolts are correctly clicked into place.



Cleaning

The cushion cover and the foam rubber padding can be washed at 60° with a mild detergent. The padding should be washed separately.

Please use a damp cloth to clean the seat and backrest surfaces, the frame and the wheels. The padding should be removed for cleaning and replaced only when completely dry.

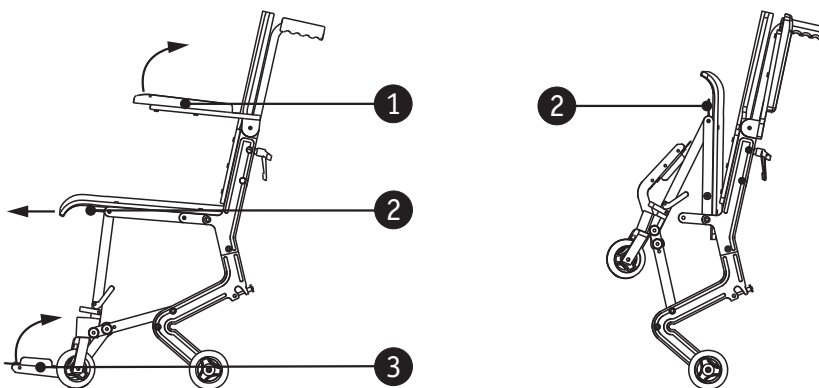

Transport of the scalachair X3 (folding model)

The following instructions do not apply to the rigid scalachair X3 model.

For transportation purposes the scalachair can be folded together. Fold the armrests [1] upward, and release the seat locking bolts [2] by pulling. Then, the seat and the footrest [3] can easily be folded up. Before using the scalachair after transport, make sure the seat locking bolts are clicked into place. The diagram in the middle of this page illustrates the correct procedure.

Accessories

To increase the comfort of your scalachair X3, **alber** has some very useful accessories to offer.

Sliding handles [1] make passenger transport much easier. By loosening the capstan-headed screws [2] you can adjust the sliding handles to your own height. After adjustment, always tighten the capstan screws firmly!

The headrest increases the comfort for the passenger. You can adjust the height and distance according to the needs of the passenger. To do this, loosen the adjusting screws [4]. After adjustment, tighten them again securely!

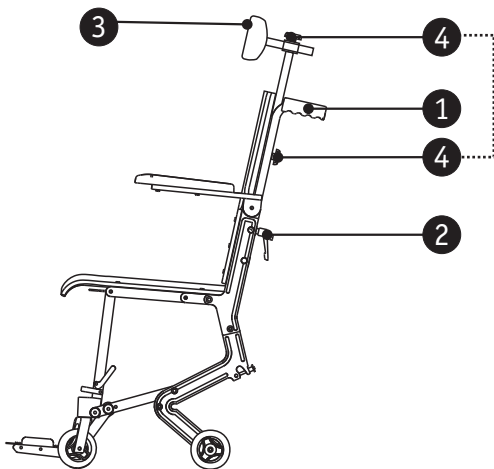

CE The scalachair X3 meets EU guidelines for medical products 93/42/EWG.

35.0002.4.99.02
Stand: 01.02.2011